



, Sopwith Way,  
, SW11

Offers In Excess Of £1,400,000, Leasehold

NAPIER WATT

T: 0207 935 0011  
E: [enquiries@napierwatt.co.uk](mailto:enquiries@napierwatt.co.uk)  
W: [napierwatt.co.uk](http://napierwatt.co.uk)

35 Berkeley Square, Mayfair, London, W1J 5BF

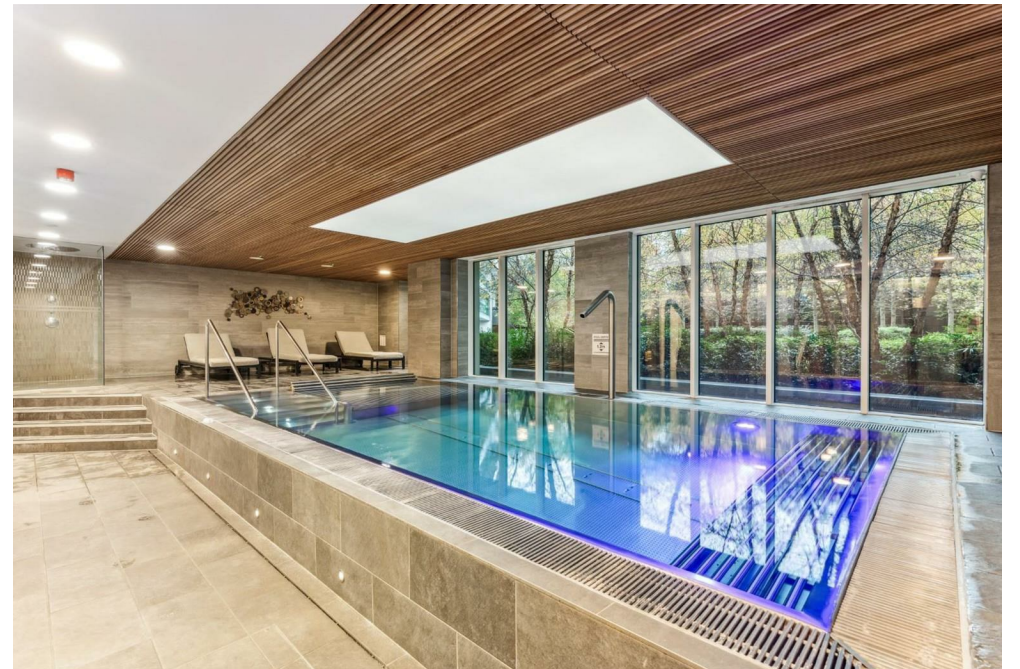





## Description

Discover this elegant south-facing 9th-floor apartment at Chelsea Vista, Chelsea Bridge. With 1,073 sq ft, it features three bedrooms, two bathrooms, two balconies, a parking space, and comfort cooling.

Enjoy abundant natural light, a master suite with en-suite, and sweeping views of Battersea Park. Residents benefit from a 24-hour concierge, gym, spa pool, and sauna. Just minutes from Battersea Power Station and Sloane Square, Vista offers unmatched elegance and connectivity.

## Key Features

- MODERN BUILT
- LUXURY AMENITIES
- UNDERGROUND PARKING SPACE
- 2\* BALCONIES
- 24 HOURS CONCIERGE
- LIFT
- FACING BATTERSEA PARK

## Terms

Council Tax Band: G, E2176.66 2023/24  
 Council: Wandsworth  
 Length of Lease: 999 years from and including 1 January 2016  
 Service Charge: £9145 per year (2024)  
 Ground Rent: £850 per year

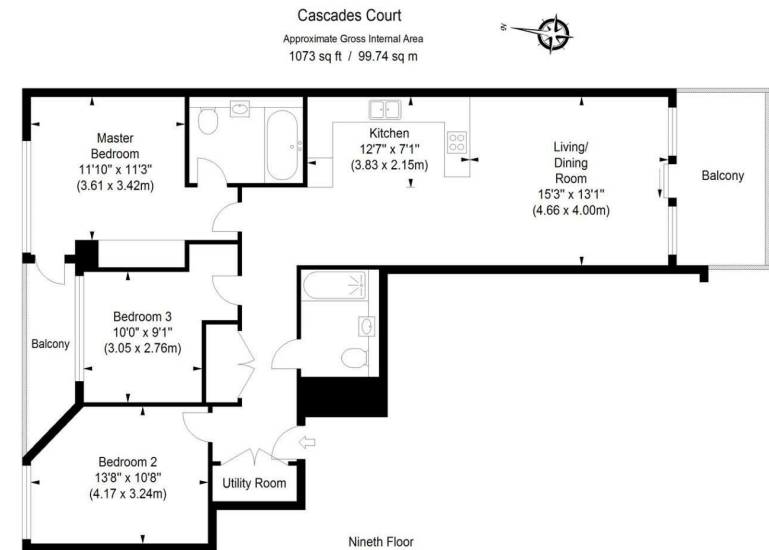

ILLUSTRATION FOR IDENTIFICATION PURPOSES ONLY

ALL MEASUREMENTS ARE MAXIMUM, AND INCLUDE WINDOW BAYS AND WARDROBES WHERE APPLICABLE  
 THIS PLAN MUST NOT BE REPRODUCED BY ANY OTHER PERSON WITHOUT PERMISSION

IMPORTANT: We would inform prospective purchasers that these sales particulars have been prepared as a general guide only. A detailed survey has not been carried out, nor the services, appliances and fittings tested. Room sizes should not be relied upon for furnishing purposes and are approximate. If floor plans are included, they are for guidance only and illustration purposes only and may not be to scale. If there are any important matters likely to affect your decision to buy, please contact us before viewing the property.